

# miniMass® Splicer Tech Tips

SLTS-004 5/2/01

A good cleave is critical to achieving low loss ribbon splices. Periodic cleaver maintenance is required to insure peak performance.

## Necessary Tools:

- Alcohol
- Cotton swabs
- Tweezers
- Lint-free tissues
- Clear tape

## Cleaning the Cleaver



**Caution:** Always wear safety glasses when cleaning the cleaver.



**Caution:** Never use compressed air to clean the cleaver. Using compressed air could blow a fiber into your eyes.



**WARNING:** Cleave glass fibers are very sharp and can pierce the skin easily. Do not let cut pieces of fiber stick to your clothing or drop in the work area where they can cause injury later. Use tweezers to pick up cut or broken pieces of the glass fibers and place them on a loop of tape kept for that purpose alone. Good housekeeping is very important.

1. Remove any fiber shards from the cleaver by using clear tape or tweezers. Dispose of the shards in a safe manner.(Figure 1).
2. Clean the cleaver pads and the anvil with a cotton swab dampened with alcohol (Figure 2).
3. Clean the cleaver blade with a lint free tissue dampened with alcohol (Figure 3).

## Cleaning the Cleaver

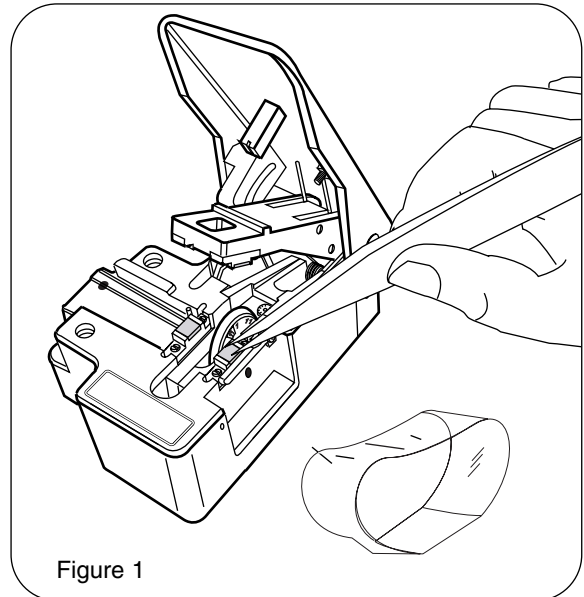

Figure 1

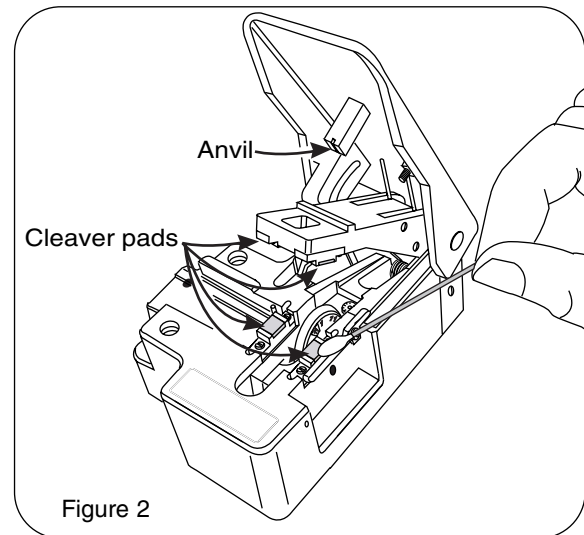

Figure 2

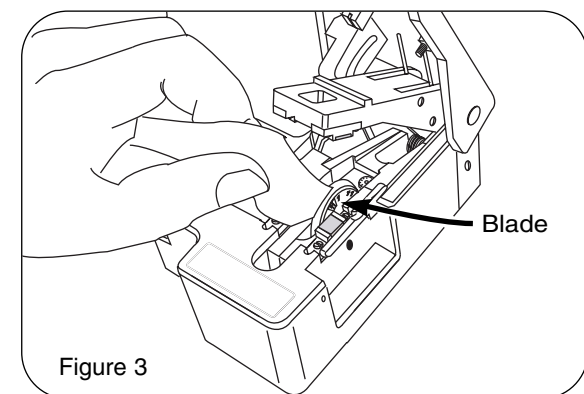

Figure 3

All trademarks are the property of their respective holders.

© 2000, 2001 Corning Cable Systems LLC. Please refer to the operating manual provided with the product described above for complete instructions and precautions.